



ESSENTIALS EMBD-FLAT (01) SW-HE

24VDC Linear Fixtures - Recessed



410.2 & 410.16
Closet Rated
up to 4.0W/ft

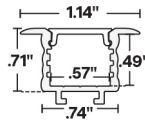
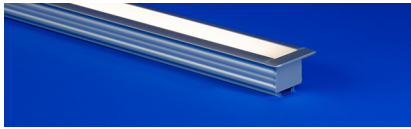

- Recessed flanged fixture designed for drywall and millwork installations
- Choose from diffused, polar, or frosted lens options for varying diode visibility and beam angles
- Flanged fixture designed for dry wall installations
- Mounting options include magnet or spring mounting clips
- Features painted end caps to match extrusion finish
- Suitable for installation in the storage area of a clothes closet when specified with LEDs at 4.0 watts or less per foot per NEC regulations
- Can be suitable for exterior use when specified as wet, contact factory for more information

INFORMATION REQUIRED FOR LIGHTING SCHEDULE

1	2	3	4	5	6
PRODUCT	WATTS/ FT	CCT	RATED	EFFICIENCY	LENS
				STD	

ADDITIONAL INFORMATION REQUIRED TO ORDER

7	8	9	10	11	12	13	14	15
WIRE INPUT/ OUTPUT	CONNECTOR/ WIRE IN	CONNECTOR/ WIRE OUT	WIRE COLOR	WIRE TYPE	MOUNTING	FINISH	LENGTH (IN)	EXACT/ OPTIMAL

Sample Part Number: **EB1SW-3.0HE-30-DRY-STD-DF-P1-BW-BW-BK-CL2-SP-ST-48"-E**

1 PRODUCT EB1SW EB1SW-USA Select USA option for BAA and BABA projects. SW-HE only. Only DRY ratings apply. See following pages for compatible power supplies.	2 WATTS/FT 1.5HE 1.5W/ft HE 3.0HE 3.0W/ft HE 6.0HE 6.0W/ft HE 3.0HE+ 3.0W/ft HE+ 6.0HE+ 6.0W/ft HE+ 1.5HE 1.5W/ft HE 3.0HE 3.0W/ft HE 6.0HE 6.0W/ft HE 3.0HE+ 3.0W/ft HE+	3 CCT 20 2000K 22 2200K 24 2400K 27 2700K 30 3000K 35 3500K 40 4000K 27 2700K 30 3000K 35 3500K 40 4000K 24 2400K 27 2700K 30 3000K 35 3500K 40 4000K 27 2700K 30 3000K 35 3500K 40 4000K	4 RATED DRY IP20 DMP IP54 WET IP67 Can be suitable for exterior use, contact factory for more information	5 EFFICIENCY STD Standard	6 LENS DF Diffused PR Polar FR Frosted For representation of LED visibility, see Diode Visibility section on following pages. For beam angles, see Photometric Performance section on following pages			
7 WIRE INPUT/OUTPUT SINGLE (Input only) S1 End Feed S2 Bottom Feed PASS THROUGH (Input/output) P1 End Feed P2 Bottom Feed	8 CONNECTOR/WIRE IN BW Bare Wire (Standard 24") BRL Barrel CON6 Connector 6" CON24 Connector 24" BW Bare Wire (Standard 24") BRL Barrel CON6 Connector 6" CON24 Connector 24"	9 CONNECTOR/WIRE OUT CLS Closed End (No feed) BW Bare Wire (Standard 24") BRL Barrel CON6 Connector 6" CON24 Connector 24"	10 WIRE COLOR WH White BK Black N/A For Barrel wet barrel only available in black	11 WIRE TYPE CL2 Class 2 CL2P Plenum Rated N/A For Barrel CL2P only available with bare wire leads (BW)	12 MOUNTING SP Spring Clip MG Magnet	13 FINISH ST Satin CU Custom Custom finishes require a longer lead time, consult factory	14 LENGTH (IN) Minimum length is 12", maximum length is 98" not including end caps. Contact us for lengths under 12".	15 EXACT/OPTIMAL O Optimal Illumination E Exact Specified Length Exact fixtures match the exact length you specify, but they may have dim spots at the ends. Optimal fixtures are slightly shorter than the length specified, but provide full illumination from end to end. See Exact/Optimal Fixture Length charts.

For continuous mounting, consider bottom feed.

BW: Standard length is 24". Max length is 120".
Request custom length by writing in part number next to BW (example: BW48)

BW: Standard length is 24". Max length is 120".
Request custom length by writing in part number next to BW (example: BW48)



ESSENTIALS EMBD-FLAT (01) SW-HE

24VDC Linear Fixtures - Recessed

1 PRODUCT - DIMENSIONS

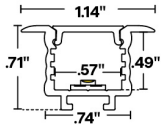

Profile with flat lens

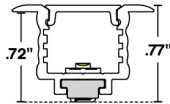

Profile with flat lens and magnet mounting clip

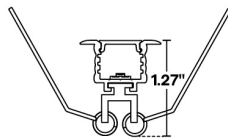

Profile with flat lens and spring mounting clip



Spring mounting clip

2 DELIVERED LUMENS

[Calculated L70 = 70000 hrs, L70 = 50000 for HE+]
Tested with EB1SW-**-30-DRY-STD

	1.5HE W/FT		3.0HE W/FT		3.0HE+ W/FT		6.0HE W/FT		6.0HE+ W/FT	
	LM/FT	CRI	LM/FT	CRI	LM/FT	CRI	LM/FT	CRI	LM/FT	CRI
FR	159	98	291	98	418	92	551	98	773	92
PR	141	98	259	98	364	92	491	98	673	92
DF	121	98	222	98	309	92	421	98	571	92

6 DIODE VISIBILITY

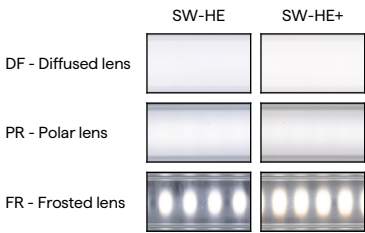

TEMPERATURE RATINGS

		1.5 HE W/FT		3.0 HE W/FT		3.0 HE+ W/FT		6.0 HE W/FT		6.0 HE+ W/FT	
		Min	Max	Min	Max	Min	Max	Min	Max	Min	Max
DRY	Ambient Operating Temp - Recessed	-4°F	140°F	-4°F	135°F	-13°F	135°F	-4°F	110°F	-13°F	110°F
DMP	Ambient Operating Temp - Recessed	-4°F	135°F	-4°F	130°F	**	**	-4°F	105°F	**	**
WET	Ambient Operating Temp - Recessed	-4°F	135°F	-4°F	130°F	-13°F	130°F	-4°F	105°F	**	**



ESSENTIALS EMBD-FLAT (01) SW-HE

24VDC Linear Fixtures - Recessed

7 WIRE INPUT/OUTPUT

SINGLE (Input only)

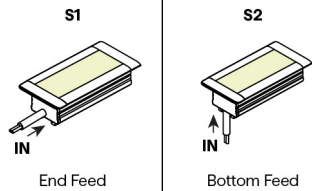

PASS THROUGH (Input/Output)

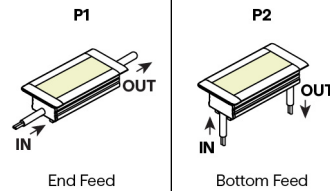

CONFIGURATION OPTIONS

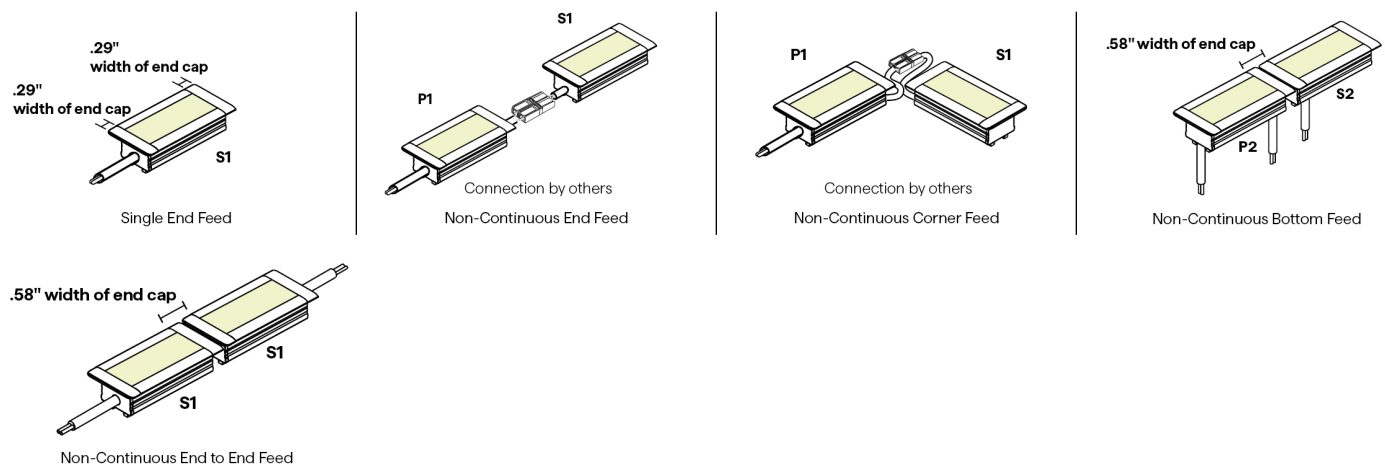

8 / 9 CONNECTOR/WIRE - IN/OUT

Connector/Wire In or Out not needed to specify product. Standard configuration is BW for Wire In and CLS for Wire out

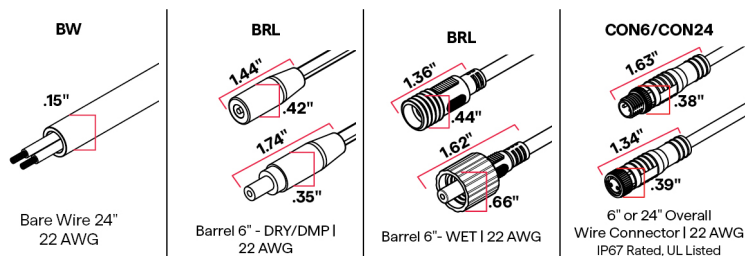

10 WIRE COLOR





ESSENTIALS EMBD-FLAT (01) SW-HE

24VDC Linear Fixtures - Recessed

12 MOUNTING

SP



Spring Clip

2 clips provided for 4' or less. 4 clips provided for greater than 4'.

To order separately use SP-01

MG



Magnet Clip

One MG provided per foot
To order separately use MG-02

MMA-02

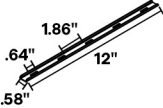

Magnet Mount
Accessory for MG-02

Sold separately, to order use MMA-02

Each bracket comes with 2 #6 x 5/8" Flat Head SS

Required when mounting to a non-magnetic surface

13 FINISH



Satin

Custom finishes require a longer lead time, consult factory

Custom finishes require a longer lead time, consult factory

14 EXACT/OPTIMAL FIXTURE LENGTH

[E/O Length Calculator →](#)

[E/O Explained →](#)

Exact fixtures are the exact length specified. Optimal fixtures' length is rounded down based on LED cut points to allow the fixture to be illuminated end to end. For runs with multiple fixtures that need to fill a specific length, it's recommended to order all optimal fixtures with an exact fixture at the end of the run.

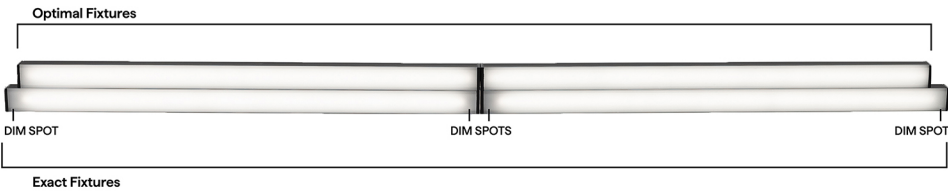

SW-HE, SW-HE+ DRY DMP LENGTHS BY INCH

EXACT LENGTH

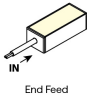
Requested Length	Potential dim spot on either end of a S1 fixture  End Feed
12"	1"
13"	0.5"
14"	1"
15"	0.5"
16"	1"
17"	0.5"
18"	1"
19"	0.5"
20"	1"
21"	0.5"
22"	1"
23"	0.5"
24"	1"
36"	1"
48"	1"
60"	1"
72"	1"
84"	1"
96"	1"

OPTIMAL LENGTH

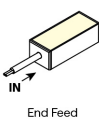
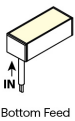
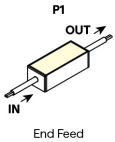
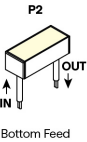
Requested Nominal Length	S1 & S2		P1 & P2	
	 End Feed	 Bottom Feed	 End Feed	 Bottom Feed
12"	10.41"		10.66"	
13"	12.41"		12.66"	
14"	12.41"		12.66"	
15"	14.41"		14.66"	
16"	14.41"		14.66"	
17"	16.41"		16.66"	
18"	16.41"		16.66"	
19"	18.41"		18.66"	
20"	18.41"		18.66"	
21"	20.41"		20.66"	
22"	20.41"		20.66"	
23"	22.41"		22.66"	
24"	22.41"		22.66"	
36"	34.41"		34.66"	
48"	46.41"		46.66"	
60"	58.41"		58.66"	
72"	70.41"		70.66"	
84"	82.41"		82.66"	
96"	94.41"		94.66"	



ESSENTIALS EMBD-FLAT (01) SW-HE

24VDC Linear Fixtures - Recessed

SW-HE+ WET LENGTHS BY INCH

EXACT LENGTH

Requested Length	Potential dim spot on either end of a S1 fixture
	S1
12"	1"
13"	0.5"
14"	1"
15"	0.5"
16"	1"
17"	0.5"
18"	1"
19"	0.5"
20"	1"
21"	0.5"
22"	1"
23"	0.5"
24"	1"
36"	1"
48"	1"
60"	1"
72"	1"
84"	1"
96"	1"

OPTIMAL LENGTH

Requested Nominal Length	S1 & S2	P1 & P2
	S1 End Feed Bottom Feed	P1 End Feed Bottom Feed
12"	10.61"	10.76"
13"	12.61"	12.76"
14"	12.61"	12.76"
15"	14.61"	14.76"
16"	14.61"	14.76"
17"	16.61"	16.76"
18"	16.61"	16.76"
19"	18.61"	18.76"
20"	18.61"	18.76"
21"	20.61"	20.76"
22"	20.61"	20.76"
23"	22.61"	22.76"
24"	22.61"	22.76"
36"	34.61"	34.76"
48"	46.61"	46.76"
60"	58.61"	58.76"
72"	70.61"	70.76"
84"	82.61"	82.76"
96"	94.61"	94.76"

COMPATIBLE POWER SUPPLIES

See power supplies cut sheets for more information. Data subject to change, all data has +/- 5% tolerance.

DIM TO LEVEL	INDOOR	OUTDOOR
	SW24/5.0, SW-HE, SW-HE+	SW24/5.0, SW-HE, SW-HE+
Dim to Black	Q6M-DC+CAP QTM-DC+CAP iQ-PH+QD1	QOM-DC+CAP QOM-PH
0.1%	QT-CAB-QZ-PH/0-10V QT-CAB-eLED+0-10V QT-CAB-eLED+0-10V-AWN QT-CAB-eLED+DALI-DT6 QT-CAB-eLED+DALI-DT6-AWN QTM-eLED+0-10V QTM-eLED+0-10V-AWN QTM-eLED+DALI-DT6 QTM-eLED+DALI-DT6-AWN QZ-BOWTIE+DIMMER QZ-DMX QZ-PH/0-10V QZ-STICK-PH/0-10V QZLP	Q-SET-QZ-DMX Q-SET-QZ-PH/0-10V Q-SET-eLED+0-10V QOM-eLED+0-10V QOM-eLED+DALI-DT6 QOM-eLED+PS-DALI-DT6 QZ-DMX QZ-PH/0-10V
1%	QTM-eLED(E) QZ-DALI-DT6	Q-SET+QZ-DALI-DT6 QZ-DALI-DT6
10%	Non-Dim Power Supply with SW App Dongle	



ESSENTIALS EMBD-FLAT (01) SW-HE

24VDC Linear Fixtures - Recessed

DIMMING PROTOCOL	INDOOR	OUTDOOR
	SW24/5.0, SW-HE, SW-HE+	SW24/5.0, SW-HE, SW-HE+
Non-Dim	QT-CAB-eLED-ND QTM-eLED-ND QZ-ND	Q-SET-QZ-ND Q-SET-eLED-ND QOM-eLED-ND QZ-ND
Phase	Q6M-DC+CAP QT-CAB-QZ-PH/0-10V QTM-DC+CAP QTM-eLED(E) QZ-BOWTIE+DIMMER QZ-PH/0-10V QZ-STICK-PH/0-10V QZLP iQ-PH+QD1	Q-SET-QZ-PH/0-10V QOM-DC+CAP QOM-PH QZ-PH/0-10V
0-10V	QT-CAB-QZ-PH/0-10V QT-CAB-eLED+0-10V QT-CAB-eLED+0-10V-AWN QTM-eLED+0-10V QTM-eLED+0-10V-AWN QZ-PH/0-10V QZ-STICK-PH/0-10V QZLP	Q-SET-QZ-PH/0-10V Q-SET-eLED+0-10V QOM-eLED+0-10V QZ-PH/0-10V
Lutron Athena	QT-CAB-eLED+0-10V-AWN QT-CAB-eLED+DALI-DT6-AWN QTM-eLED+0-10V-AWN QTM-eLED+DALI-DT6-AWN	
ECO System	QTM-eLED(E)	
DMX	QZ-DMX	Q-SET-QZ-DMX QZ-DMX
DALI-2: DT6	QT-CAB-eLED+DALI-DT6 QT-CAB-eLED+DALI-DT6-AWN QTM-eLED+DALI-DT6 QTM-eLED+DALI-DT6-AWN QZ-DALI-DT6	Q-SET+QZ-DALI-DT6 QOM-eLED+DALI-DT6 QZ-DALI-DT6
SCENE App Dimmed	Non-Dim Power Supply with SW App Dongle	

COMPATIBLE MOUNTING ACCESSORIES

MMA-02



.58"

Magnet Mount Accessory
of MG-02